

WASHBURN COUNTY FOREST
INTEGRATED MANAGEMENT / PROSPECTUS WORKSHEET

Tract # 12-26

DESCRIPTION:

NESW, SESW, SWSW Sec. 27; SW, SWNW Sec. 34; T41N-R13W (CHICOG)

VOLUME, SPECIES & PRICE:

2100 Tons Red pine (~935 Cd., ~75 mbf)
60 Tons Jack pine (~30 Cd.)

TOTAL MINIMUM BID: \$ 25,560.00

NOTE: 3-year contract

CUTTING INSTRUCTIONS:

AREA A [Red Pine]: Harvest all orange marked red and jack pine within the designated boundaries. (89 acres)

Access, Roads, and Landings:

- No new roads will be permitted. Reconstruction of existing forest trails will be needed.
- Landings shall be located where indicated on the prospectus map unless prior approval is obtained from the County Forest Administrator.
- Decking of wood allowed along fire lanes as long as the decked wood does not extend out onto the road surface.

Seasonal Restrictions:

- All pine cut or piled between May 1st and August 1st shall be removed within 30 days.

Recreation:

- Recreation trail surface will have to be restored to at least existing condition and any damaged signs/posts will have to be replaced by the contractor.
- Recreation trail shall be maintained snow covered during winter months and free of debris at all times.

BMP's:

- No slash will be left in any non-forested wetlands. Do not operate wheeled or tracked equipment within 15ft of wetlands except during frozen conditions.

Skidding:

- No pole skidding allowed April 1st through July 31st without permission.

Private Land:

- No slash or logging debris will be left across the blue line onto private land.

All additional restrictions listed on the prospectus sheet apply unless otherwise specified.

MANAGEMENT CONSIDERATIONS

Area A: Is comprised of 40-48-year-old red pine stands scheduled for a 2nd improvement thinning. Level topography on sandy soils with an all-season logging chance.

ACRES 89

WASHBURN COUNTY FOREST
 TIMBER SALE PROSPECTUS - TRACT 12-26
 SEC 27 & 34 T41N R13W

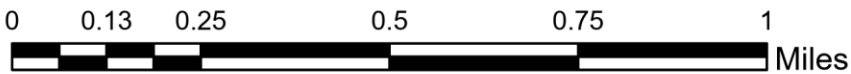
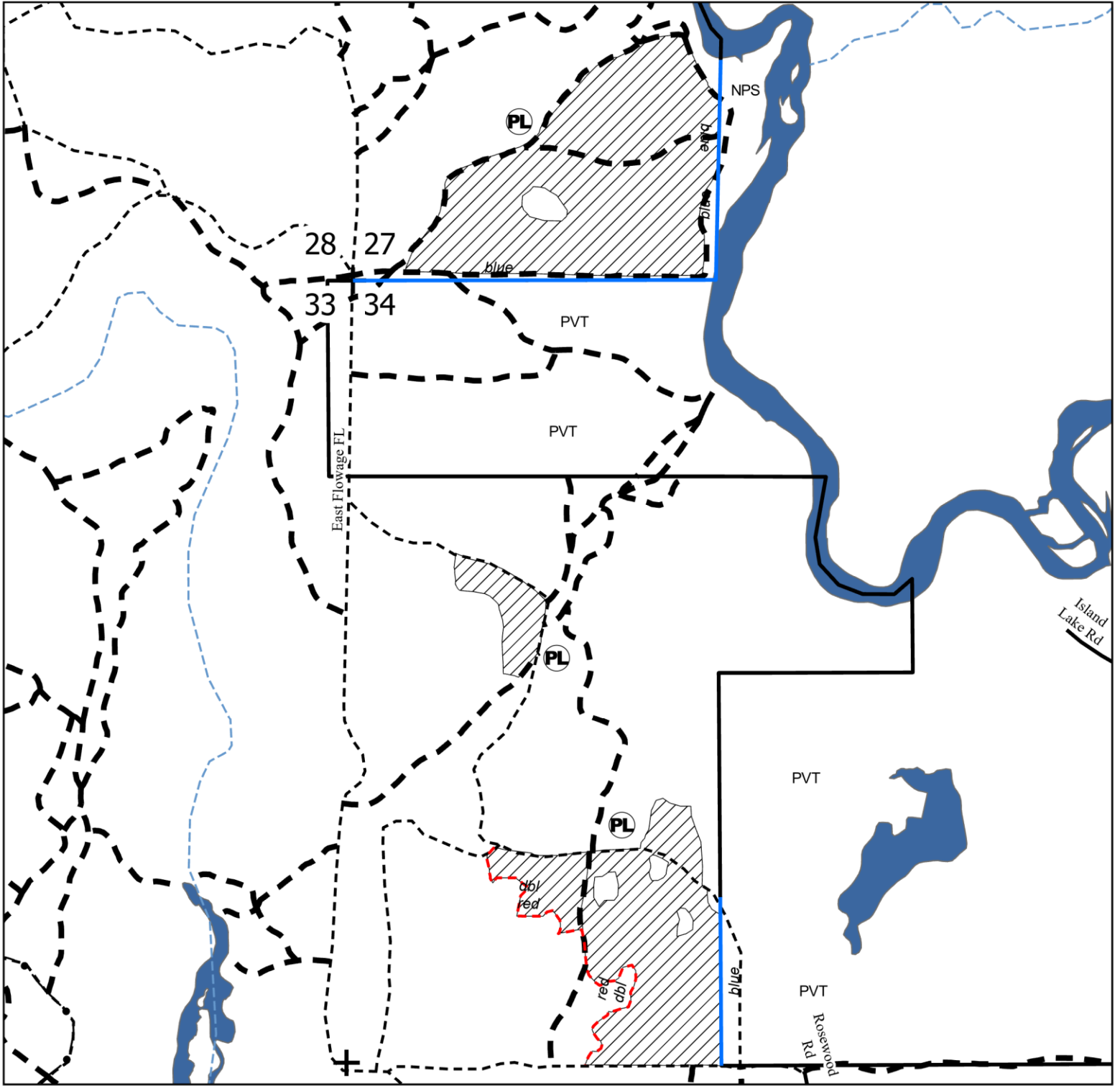

Legend

- | | | |
|-----------------------|---------------------------|------------------|
| Area A: Red Pine Thin | Corner | Township Road |
| dbl red | NPS National Park Service | Woods Road |
| blue | PVT pvt | Snowmobile Trail |
| Proposed Landing | County Forest Road | stream |

