

WASHBURN COUNTY FOREST
INTEGRATED MANAGEMENT / PROSPECTUS WORKSHEET

Tract # 11-26

DESCRIPTION:

NWNW, SWNW, NWSW, NESW, SWSW Sec. 3; SESE, NENE, NESE, NWSE Sec. 4; T40N-R13W (CASEY)

VOLUME, SPECIES & PRICE:

3570 Tons Red pine (~1580 Cd.)

TOTAL MINIMUM BID: \$ 29,988.00

NOTE: 3-year contract

CUTTING INSTRUCTIONS:

AREA A [Red Pine]: Harvest all orange marked trees within the designated boundaries. (149 acres)

Access:

- No new roads will be permitted.
- Landings shall be located where indicated on the prospectus map unless prior approval is obtained from the County Forest Administrator.
- Decking of wood allowed along fire lanes as long as the decked wood does not extend out onto the road surface.
- Decking of wood along the township roads will require written permission from the township.

Seasonal Restrictions:

- All pine cut or piled between May 1st and August 1st shall be removed within 30 days.

Recreation:

- Recreation trail surface will have to be restored to at least existing condition and any damaged signs/posts will have to be replaced by the contractor.
- Snowmobile trail shall be maintained snow covered and free of debris during the winter months.
- Recreation trail shall be maintained snow covered during winter months and free of debris at all times.

BMP's:

- No slash will be left in any non-forested wetlands. Do not operate wheeled or tracked equipment within 15ft of wetlands except during frozen conditions.

All additional restrictions listed on the prospectus sheet apply unless otherwise specified.

MANAGEMENT CONSIDERATIONS

Area A: Is comprised of 44-48, and 61-year-old red pine stands scheduled for a 2nd improvement thinning harvest. Generally level topography on sandy soils with an all-season logging chance.

ACRES 149

WASHBURN COUNTY FOREST TIMBER SALE PROSPECTUS - TRACT 11-26 SEC. 3 AND 4 T40N-R13W (CASEY)

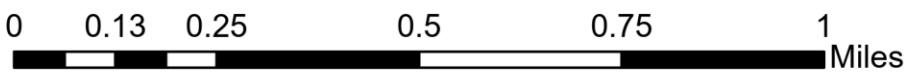
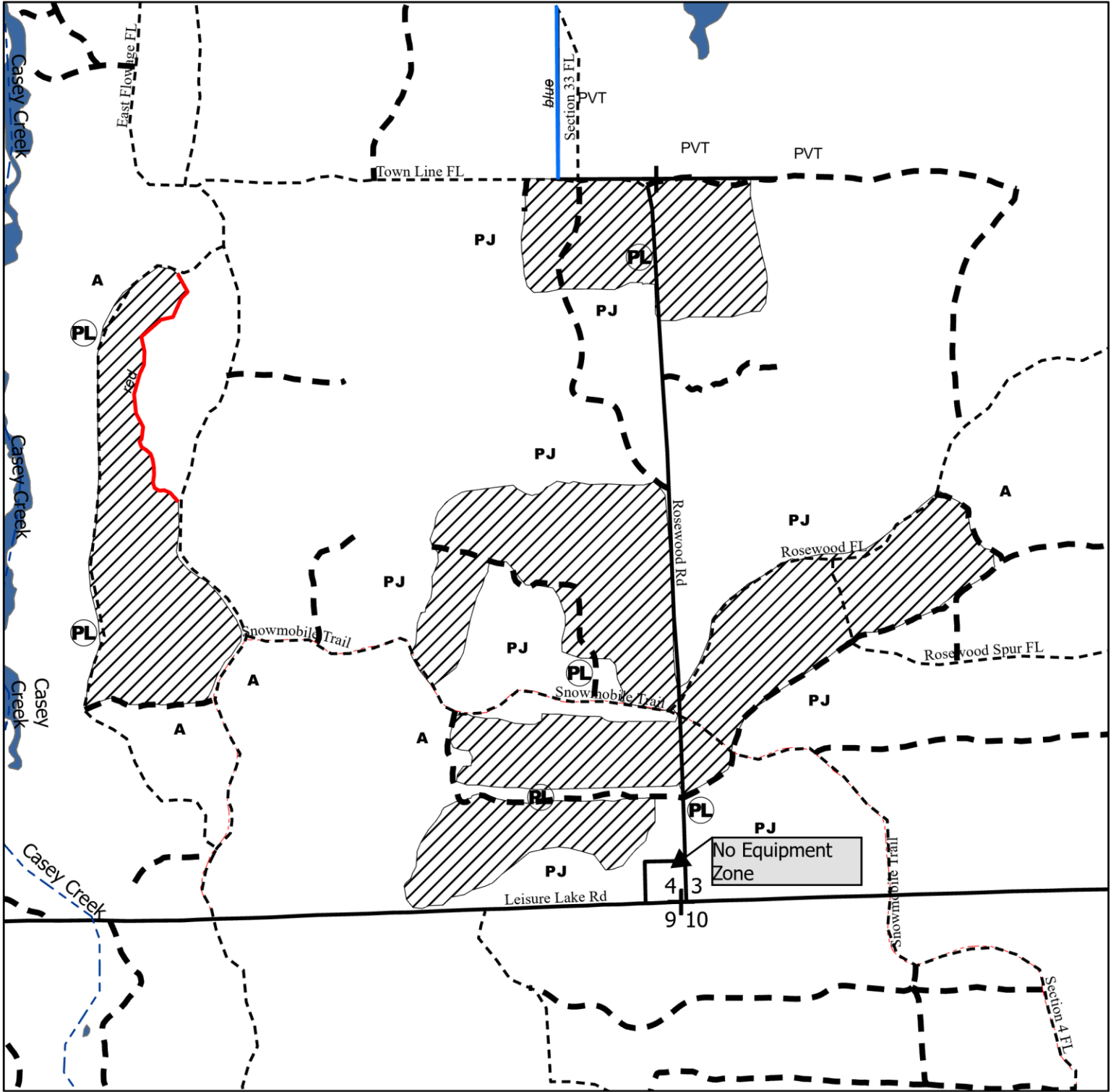

	Area A: Red Pine Thin	A	Aspen		stream
	Proposed Landing	PJ	PJ		Waterbody
	Corner		private line		
PVT	pvt		red		