

WASHBURN COUNTY FOREST
INTEGRATED MANAGEMENT / PROSPECTUS WORKSHEET

Tract # 15-26

DESCRIPTION: NWSE, Sec. 21; T37N-R13W (BARRONETT)

VOLUME, SPECIES & PRICE:

840 Tons White Spruce (~420 cd., includes 100 mbf, 5% red pine) 2.0 tons/cd

TOTAL MINIMUM BID: \$ 3,612.00

NOTE: 3 Year contract
No Biomass Harvesting

CUTTING INSTRUCTIONS:

AREA A [White Spruce]: Harvest all white spruce and red pine trees within designated boundaries. Harvesting techniques should minimize damage to established hardwood saplings. (19 Acres)

Access, roads & landings:

- No new roads will be permitted. Reconstruction of existing forest trails is required.
- Landings shall be located where indicated on the prospectus map unless prior approval is obtained from the County Forest Administrator.
- Decking of wood along the township roads will require written permission from the township.
- Gate to sale area shall be closed during non-working hours.

Seasonal Restrictions:

- Pine/spruce cut or piled between May 1st and August 1st shall be removed within 30 days to prevent bark beetle infestation.

BMP's:

- No slash will be left in any non-forested wetlands, ephemeral ponds, open water or designated stream channels. Do not operate wheeled or tracked equipment within 15 feet of wetlands or 50 feet of ordinary high-water mark of lake except during frozen conditions.

Private Land:

- No slash or logging debris will be left across the blue line onto private land.

All additional restrictions listed on the prospectus sheet apply unless otherwise specified.

MANAGEMENT CONSIDERATIONS

Area A: Is a 70-year-old white spruce plantation scheduled for an over story removal for conversion to Northern Hardwoods. Level to gently rolling topography with an all-season logging chance.

ACRES 19

WASHBURN COUNTY FOREST
 TIMBER SALE PROSPECTUS - TRACT 15-26
 SEC. 21 T37N-R13W (BARRONETT)

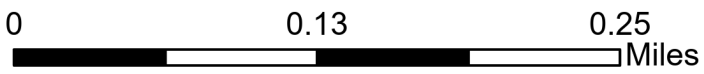
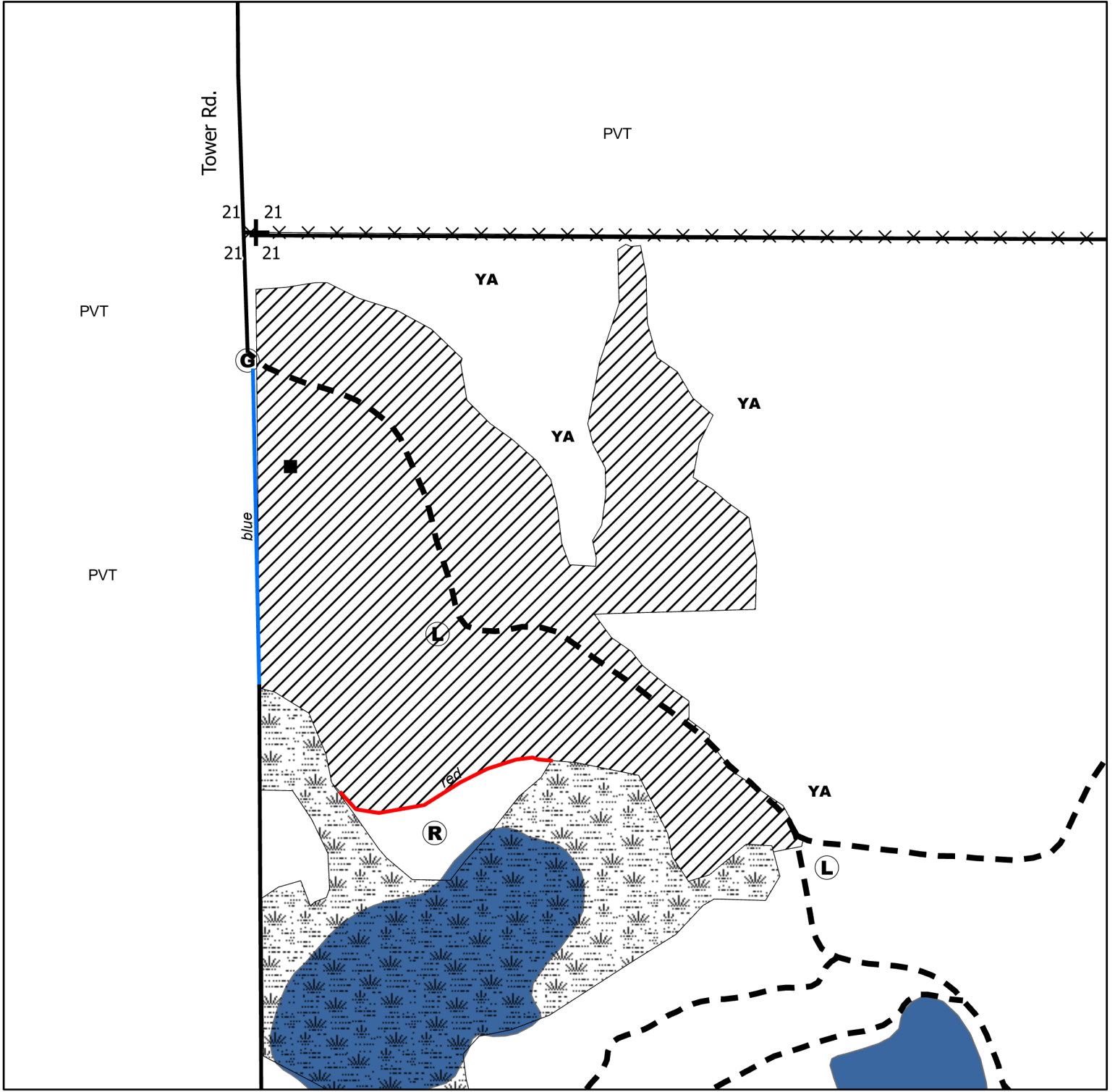

Area A: White Spruce OSR	RMZ	YA Young Aspen	blue
Area H: Wetland	Corner	fence	stream
Gate	Foundation	private line	Waterbody
Landing	PVT pvt	red	