

WASHBURN COUNTY FOREST
TIMBER SALE PROSPECTUS

Tract # 23-22 Comp. # 101

DESCRIPTION: S1/2NE, SENW SEC 5 T42N R12W (E. Minong)

VOLUME, SPECIES & PRICE:

1700 Tons Red Pine* (~445 cds, includes ~15MBF)
40 Tons Jack Pine (~20 cds)

TOTAL MINIMUM BID **\$17,524.00**

3 YEAR CONTRACT

***NOTE: The red pine sawlogs and cordwood are combined and will be sold together on a per ton basis.**

CUTTING INSTRUCTIONS:

Area A [Red Pine] First thinning: Harvest every third row, leaving 2 rows intact on the outside edges of the plantation. Individual rows are not marked. Skip low stocked red pine areas that will result in corridors wider than 20 feet. Also harvest all jack pine within the plantations boundaries.(39 acres)

Area B [Red Pine]: Harvest all orange marked trees. (5 acres)

Seasonal Restrictions:

- All pine cut or piled between May 1 and August 1 shall be removed within 30 days.
- No ground skidding allowed April 1 through July 31 without special permission.

Access:

- No new roads will be permitted. Woods roads shall remain open and free of debris.
- Decking of wood is allowed along graded roads as long as the decked wood does not extend out into the road surface.
- Designated skid trail access to area B

Slash:

- No slash or logging debris will be left across the blue line onto private land.
- No slash will be allowed on or within 10 feet of the Crooked River Fire lane.

All additional restrictions listed on the prospectus sheet apply unless otherwise specified.

MANAGEMENT CONSIDERATIONS

Area A: 1st Thinning of a 35 year old red pine plantations rows are around 7 feet on center. Average diameter is 7" dbh with a small amount of sawlog red pine also scattered jack pine and white pine.

Area B: 3rd Thinning of a 57 year old red pine plantation with a high volume of MBF included in the tonnage volume, average diameter of cut trees is > 9" DBH.

Rolling topography on sandy soils. All season logging options.

ACRES 44 acres

WASHBURN COUNTY FOREST
TIMBER SALE PROSPECTUS - TRACT 23-22
SEC4,5 T42N R12W

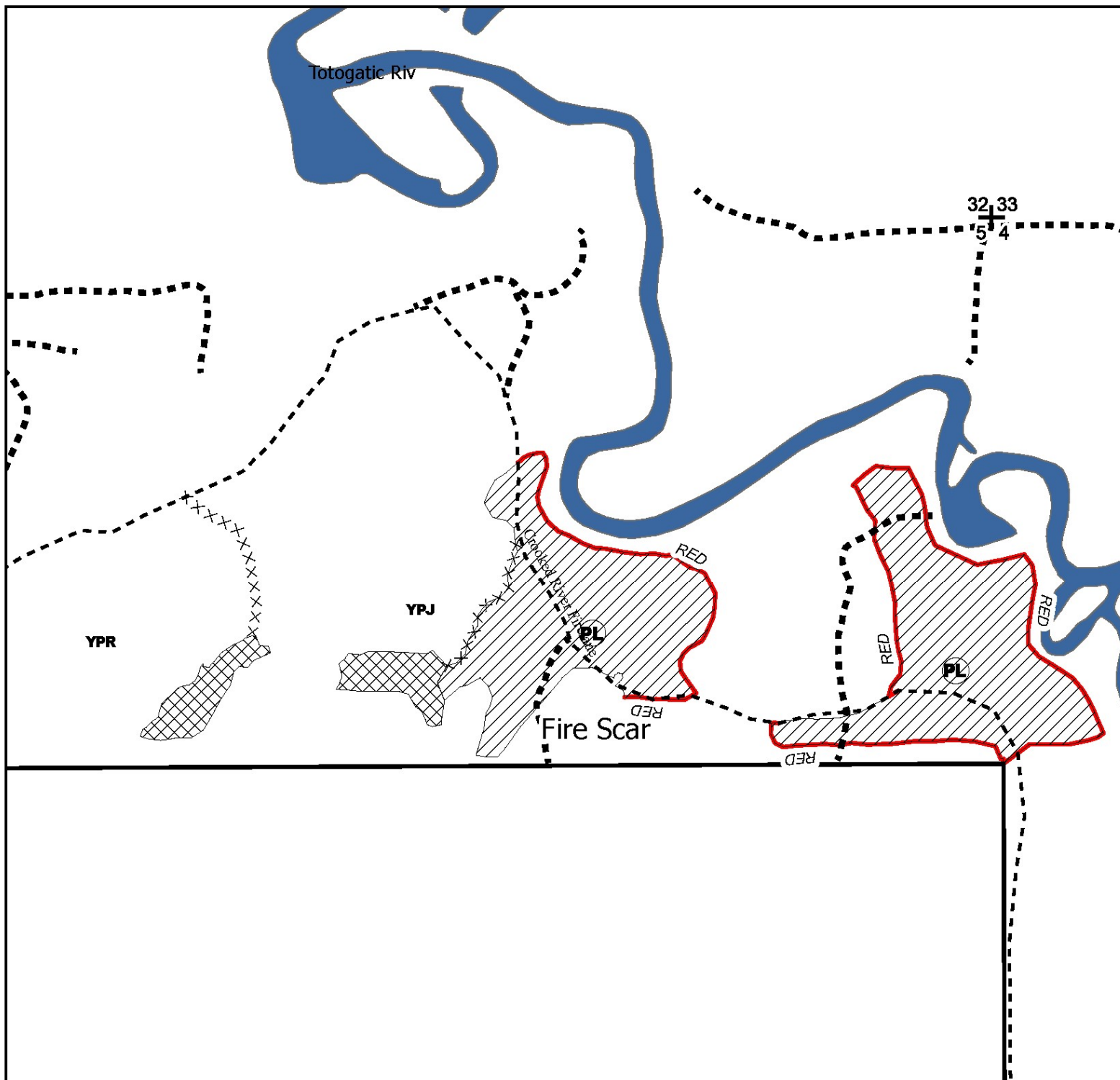

0 0.05 0.1 0.2 0.3 0.4 Miles

---- COUNTY FOREST ROAD

WATERBODY

AREA A: ROW THIN

AREA B: MARKED THIN

PL PROPOSED LANDING

+ CORNER

YPJ YPJ

YPR YPR

— PRIVATE LINE

xxx SKID CORRIDOR

RED

