

WASHBURN COUNTY FOREST
INTEGRATED MANAGEMENT / PROSPECTUS WORKSHEET
SALE #

Tract # 22-24

DESCRIPTION: S1/2SE Sec. 7, W1/2NW, W1/2SW Sec. 17, NE Sec. 18 T41N-R11W (Gull Lake)

VOLUME, SPECIES & PRICE:

1880 Tons Red Oak (~680 cds.)
730 Tons Mixed Hdwd. (~300 cds. 39% red maple, 34% ash, 21% hard maple, 4% white birch and 2% white oak) 2.36 ton/cd
200 Tons Basswood (~100 cds.)
30 Tons Aspen (~15 cds.)

82 MBF Red Oak
19 MBF Mixed Hdwd. (55% ash, 39% red maple, 3% hard maple, 2% white oak and 1% white birch)
12 MBF Basswood

TOTAL MINIMUM BID \$46,442.00

No Biomass Harvesting allowed.

Note: 2 year contract

No harvesting activity from April 1 through July 15. Oak wilt restriction.

CUTTING INSTRUCTIONS:

AREA A[red oak]: Harvest all orange marked trees within designated boundaries. (103 acres)

Access, roads & landings:

- No new roads will be permitted. Reconstruction of existing forest trails will be needed.
- Landings shall be located where indicated on the prospectus map unless prior approval is obtained from the County Forest Administrator.
- Decking of wood allowed along the Gardner Lake Fire Lane as long as the decked wood does not extend out onto the road surface.

Seasonal restrictions:

- Dry summer logging chance after July 15th. Oak wilt restrictions.

BMP's:

- No slash will be left in any non-forested wetlands. Do not operate wheeled or tracked equipment within 15 feet of wetlands except during frozen conditions.

Private Land:

- No slash or logging debris will be left across the blue line onto private land.

All additional restrictions listed on the prospectus sheet apply unless otherwise specified.

MANAGEMENT CONSIDERATIONS

AREA A: Are mature 85 and 88 year old red oak stands scheduled for a final improvement thinning. Level to rolling topography slopes on sandy loam soils, dry summer logging chance after July 15th.

ACRES 103

WASHBURN COUNTY FOREST
TIMBER SALE PROSPECTUS - TRACT 22-24
SEC. 7, 17 AND 18 T41N-R11W (GULL LAKE)

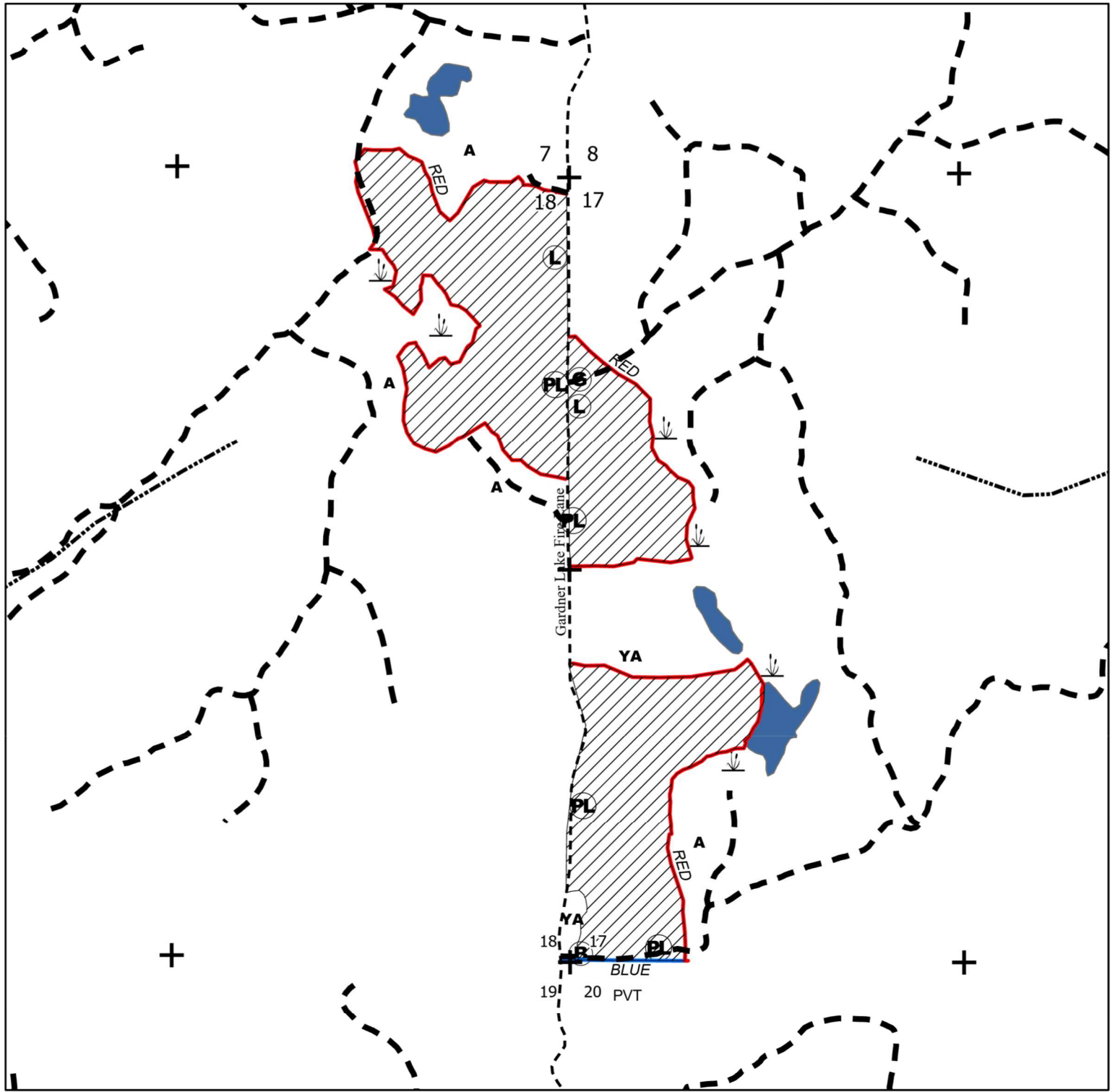

0 0.13 0.25 0.5 0.75 1 Miles

- | | | | |
|----------------------|---------|------------------|-------------|
| Area A: Red Oak Thin | Berm | Proposed Landing | Aspen |
| red | Gate | PVT pvt | Young Aspen |
| blue | Landing | Wetland | stream |