

WASHBURN COUNTY FOREST  
TIMBER SALE PROSPECTUS

Tract # 22-22      Comp. #102,103

DESCRIPTION: SESW W1/2SE Sec 7, NWNE Sec 18 T42N R12W (E. Minong)

VOLUME, SPECIES & PRICE:

**1490Tons Red Pine** (~660 cds, includes 97MBF)

**TOTAL MINIMUM BID \$14,006.00**

**3-year contract**

**NOTE: The red pine sawlogs and cordwood are combined and will be sold together on a per ton basis.**

CUTTING INSTRUCTIONS:

**AREA A** [red pine]: Harvest all orange marked trees. (69 acres)

Seasonal Restrictions:

- All pine cut or piled between May 1 and August 1 shall be removed within 30 days.
- No ground skidding allowed April 1 through July 31 without special permission.

Access:

- No new roads will be permitted. Woods roads shall remain open and free of debris.
- Decking of wood is allowed along graded roads as long as the decked wood does not extend out into the road surface.
- No decking of wood along the township roads without written permission from the township.

Slash:

- No slash will be left in town road ROW or within 2 rods of centerline.
- No slash will be allowed on or within 10 feet of the Point Fire lane.

**All additional restrictions listed on the prospectus sheet apply unless otherwise specified.**

MANAGEMENT CONSIDERATIONS

**Area A:** 3<sup>rd</sup> Thinning of red pine plantations with a high volume of MBF included in the tonnage volume. Average diameter of cut trees is > 9" DBH. Rolling topography on sandy soils. All season logging options.

ACRES 69

WASHBURN COUNTY FOREST  
TIMBER SALE PROSPECTUS - TRACT 22-22  
SEC 7, 18 T42N R12W

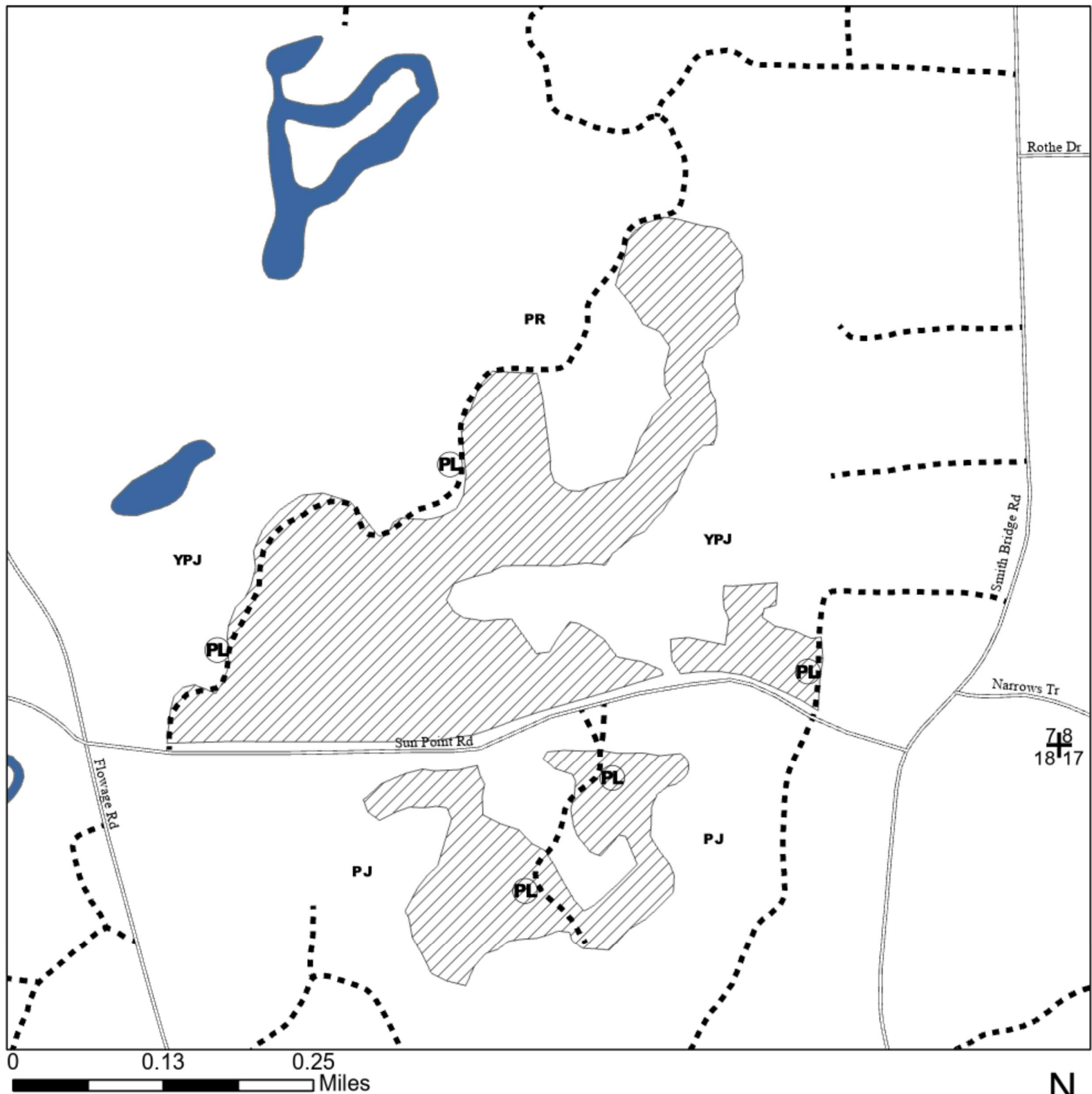

- AREA A: RED PINE
- WOODS ROAD
- WATERBODY
- PROPOSED LANDING
- TOWNSHIP ROAD