

WASHBURN COUNTY FOREST  
INTEGRATED MANAGEMENT / PROSPECTUS WORKSHEET  
SALE #

Tract # 17-22

DESCRIPTION: S1/2NE, N1/2SE, S1/2SE, SESW Sec. 19, NWNE Sec. 30, T40N-R11W (SPRINGBROOK)

VOLUME, SPECIES & PRICE:

**1555 Tons Red Pine** (690 cds. 102 mbf included)

**TOTAL MINIMUM BID \$19,593.00**

**Note: 2 year contract**

CUTTING INSTRUCTIONS:

**AREA A** [red pine]: Harvest all orange marked trees within the designated boundaries. [71 acres].

Access, roads & landings:

- ▶ No new roads will be permitted. Reconstruction of existing forest trails will be needed.
- ▶ Decking of wood allowed along the WCF fire lanes and recreation trail as long as the decked wood does not extend out onto the road/trail surface.
- ▶ Decking of wood along the township roads will require written permission from the township.
- ▶ Recreation trail surface will have to be restored to at least existing condition and any damaged signs/posts will have to be replaced by the contractor.
- ▶ Recreation trail shall be maintained snow covered during winter months and free of debris at all times.

Seasonal restrictions:

- ▶ Pine cut or piled between May 1st and August 1st shall be removed within 30 days.

Skidding:

- ▶ No pole skidding allowed April 1st through July 31st without permission.

BMP's:

- ▶ No slash will be left in any non-forested wetlands or open water. Do not operate wheeled or tracked equipment within 15 feet of wetlands or 50 feet of ordinary high water mark of lake except during frozen conditions.

**All additional restrictions listed on the prospectus sheet apply unless otherwise specified.**

MANAGEMENT CONSIDERATIONS

**Area A:** Are two 58 year old and one 49 year old red pine plantations scheduled for the third improvement thinning. Level topography on sandy soils with an all season logging chance.

ACRES



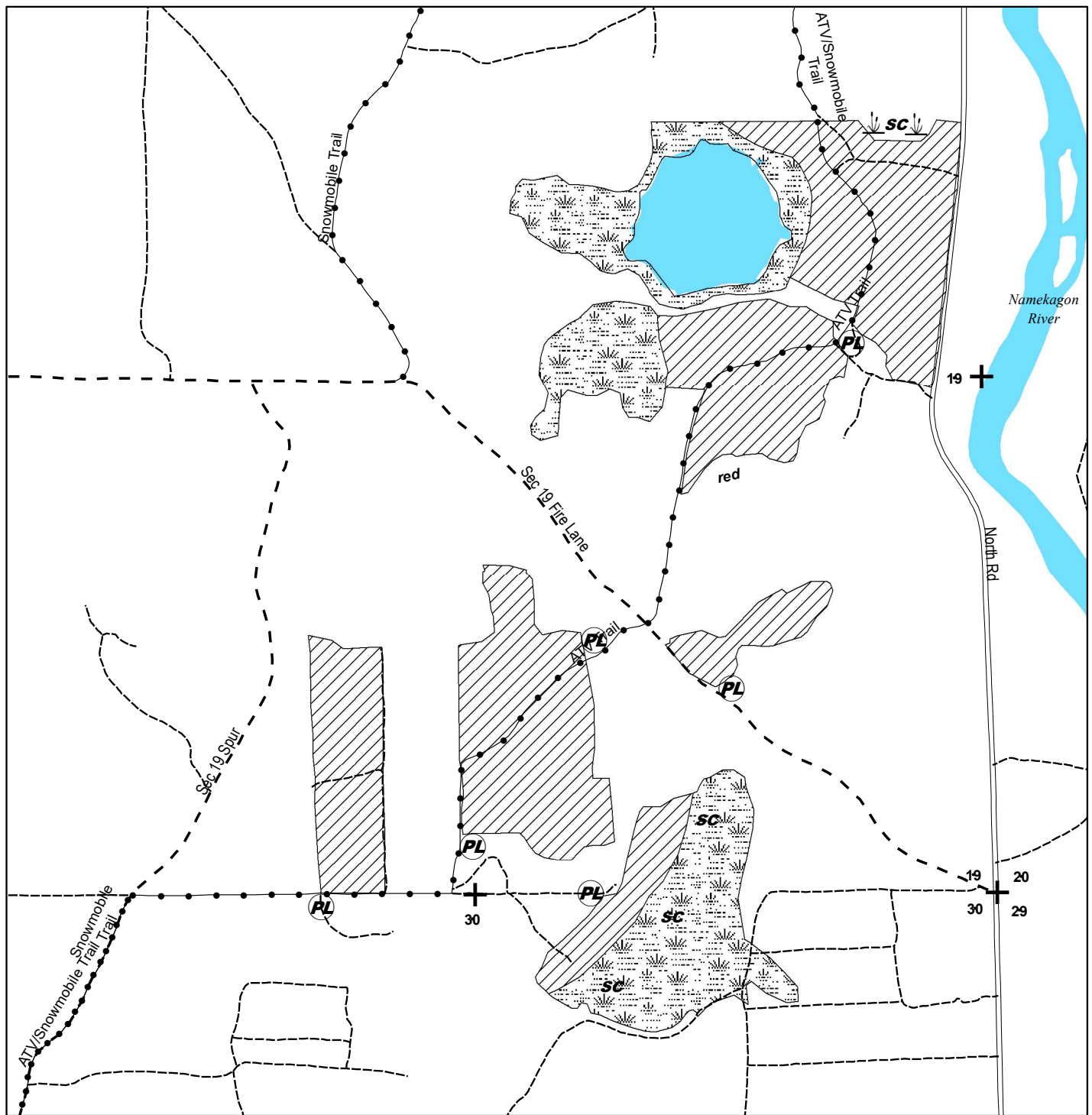

71

Washburn County Forest  
 Timber Sale Prospectus Map - Tract 17-22  
 Sec. 19, 30, T40N-R11W (SPRINGBROOK)



0 0.075 0.15 0.3 0.45 0.6 0.75 Miles

Legend

-  Proposed Landing
-  Swamp Conifer
-  Area A: Red Pine
-  Area H: Wetland
-  Wetland

